



955 Benton Ave., Winslow, ME 04901 • Phone: 1-877-564-6697 • Fax: 1-800-738-6314
Email: service@johnnyseeds.com • Web Site: Johnnyseeds.com

Materials Included

- (1) #7261 Replacement Hopper
- (3) #4 x 1/4" Torx screws
- (3) #4 Flat washers

Additional Tools Needed

- T10 Torx screwdriver

INSTRUCTIONS

1. Remove the hardware securing the old hopper using a T10 Torx screwdriver.
Note: *If you have a first generation Six-Row Seeder, the hopper's hardware will include three of each: screws, springs, and plastic bushings, which can be discarded or recycled. The #7261 Replacement Hopper is designed to be compatible with both the Second Edition Six-Row Seeder and the First Edition model, but must be installed with its own, different hardware (included).*
2. Place the brush assembly inside the hopper before positioning it snugly against the seed shaft (see #2 below).
3. Use the Torx screws and flat washers provided to secure the new hopper in place (see #3 below).

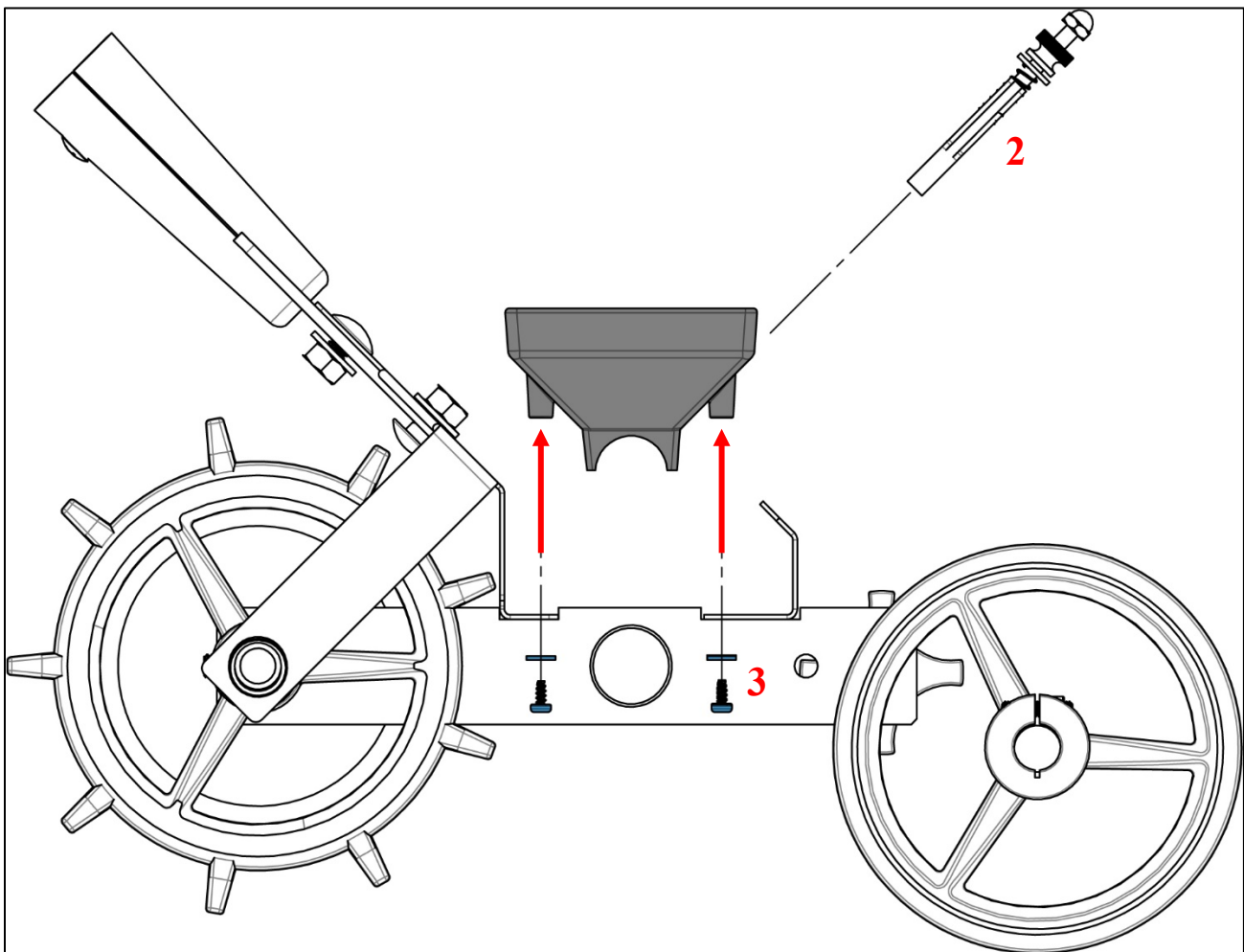

10.14.2021 | JG, ms