



955 Benton Ave., Winslow, ME 04901 • Phone: 1-877-564-6697 • Fax: 1-800-738-6314
Email: service@johnnyseeds.com • Website: Johnnyseeds.com

Required Tools

- 10mm, 13mm, and 14mm wrenches

Note: A multitool (P103-PP-027) is included with the wheel hoe for tightening up bolts in the field. It is best to use a wrench or socket set for assembly, however, to ensure the hardware is secure.

Single Wheel Hoe Parts

Single Wheel Hoe Parts List				
Description	Terrateck* Part #	Size	Compatible Wrench	Quantity
Multitool bolt tightener	P103-PP-027			1
Wood handle bolts	VH06-020-FT	M6x20	10mm	4
Wood handle tooth lock washers	RDCC06	M6		4
Handle crossbar carriage bolts	VBCC08-025-FT	M8x25		4
Handle crossbar washers	RP08-M	M8		4
Handle crossbar nylon locknuts	EHAP08	M8	13mm	4
Wood handle	P103-PP-028			2
Handle crossbar	P103-PP-201			1
Long handle	P103-AS-005			2
Mid-handle toolbar support	P103-PP-020			2
Mid-handle toolbar support carriage bolts	VBCC08-025-FT	M8x25		2
Mid-handle toolbar support washers	RP08-M	M8		2
Mid-handle toolbar support nylon locknuts	EHAP08	M8	13mm	2
Toolbar vertical support	P103-PP-019			1
Toolbar vertical support bolts	VH08-030-FT	M8x30	13mm	6
Toolbar vertical support washer	RP08-M	M8		6
Toolbar vertical support nylon locknut	EHAP08	M8	13mm	6
Toolbar holder	P103-AS-006			1
Toolbar clamp	P103-AM-002			1
Toolbar nut	EH08	M8	13mm	1
Toolbar bolt	VH08-030-FT	M8x30	13mm	1
Adjustment tool carriage bolt	VBCC08-025-FT	M8x25		1
Adjustment tool wingnut	EO08	M8		1
Toolbar horizontal support	P103-PP-022			1
Wheel support	P103-PP-023			2
Wheel nut	EHEC08-P100	M8	14mm	2
Wheel support bolt forward	VH08-45-FT	M8x45	13mm	1
Wheel support bolt back	VH08-030-FT	M8x30	13mm	1
Wheel	C000844			1

*See graphics for part illustrations.

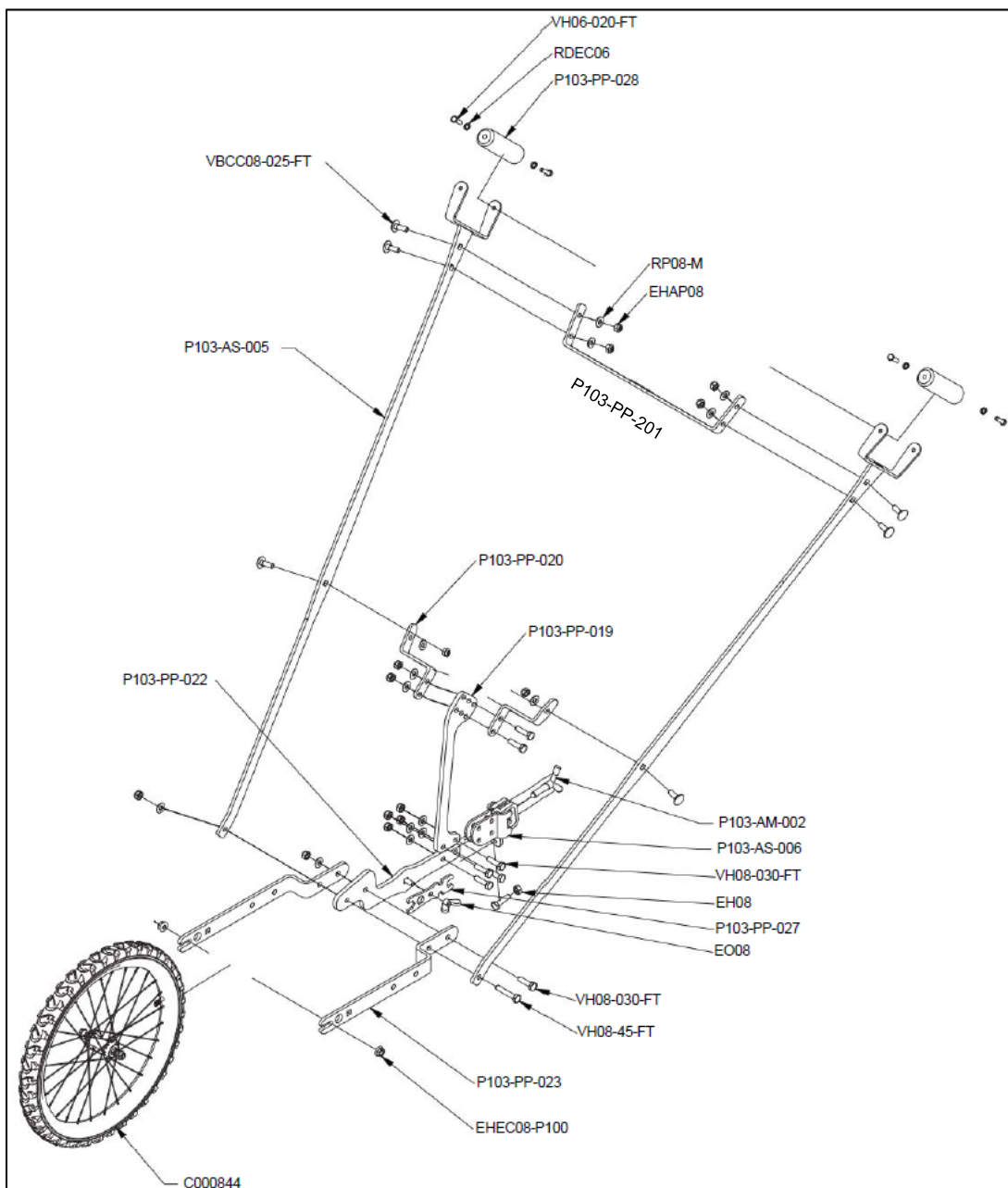

Double Wheel Hoe Conversion Parts

If you purchased a double wheel hoe, in addition to the parts illustrated above, you will also receive the following parts which allow you to convert from a single wheel hoe to double wheel hoe.

Double Wheel Hoe Conversion Parts List				
Description	Terrateck* Part #	Size	Compatible Wrench	Quantity
Wheel	C000844			1
Middle brace	C001405			1
Wheel nut	EHEC08-P100	M8	14mm	2
Two-wheel bracket	C001407			2
Wheel bracket carriage bolt	VBCC08-025-FT	M8x25		6
Wheel bracket washer	RP08-M	M8		6
Wheel bracket nylon locknut	EHAP08	M8	13mm	6

*See graphics for part illustrations.

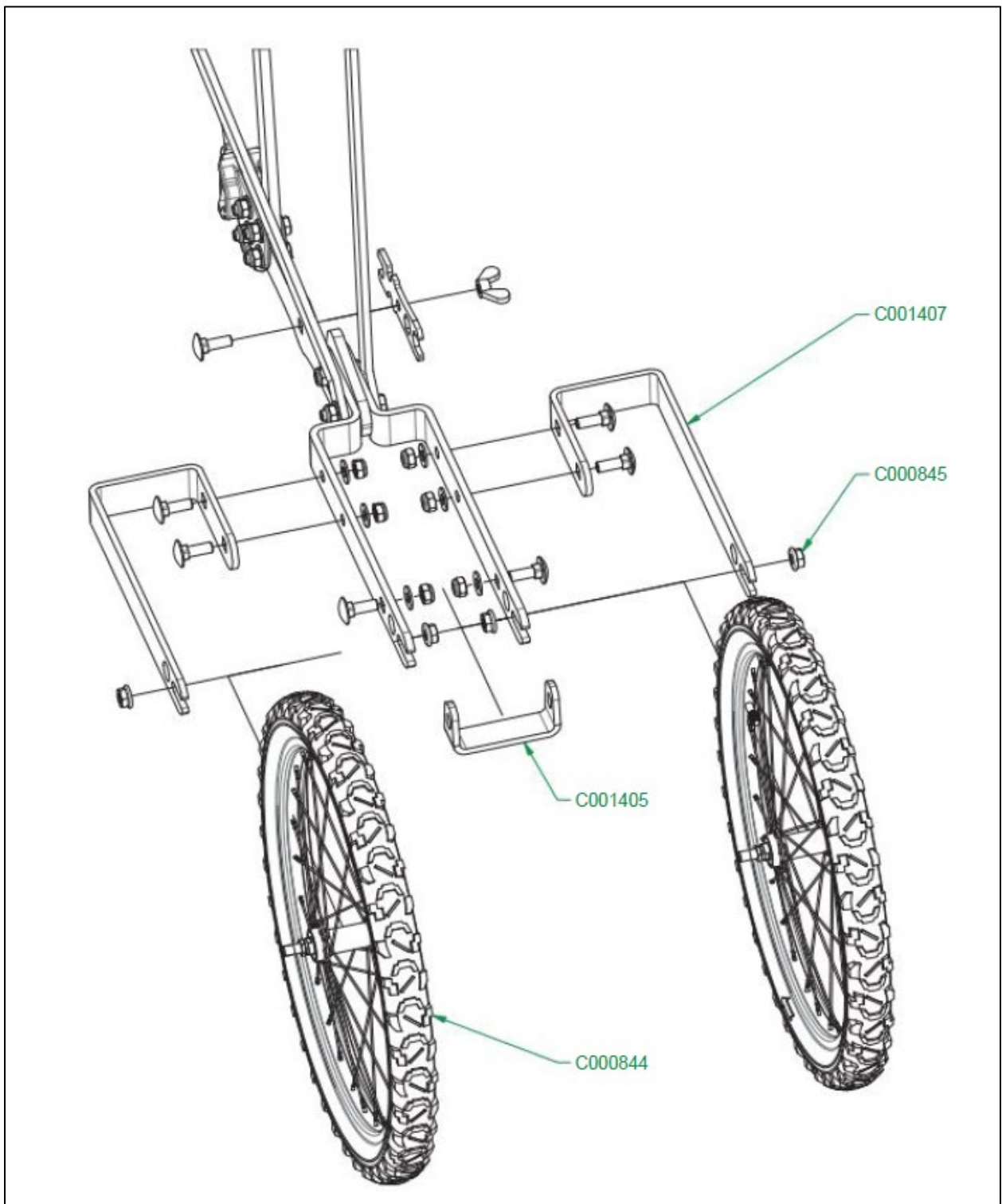

Assembly Video

Scan the QR code or visit the following url to watch a video with assembly instructions.
<https://www.youtube.com/watch?v=Qu8K8-rkrls>

Assembly

1. Attach P103-PP-023 (x2) wheel supports to P103-PP-022 using a size M8x30 bolt and M8 nut and washer. Lightly hand tighten the bolt.

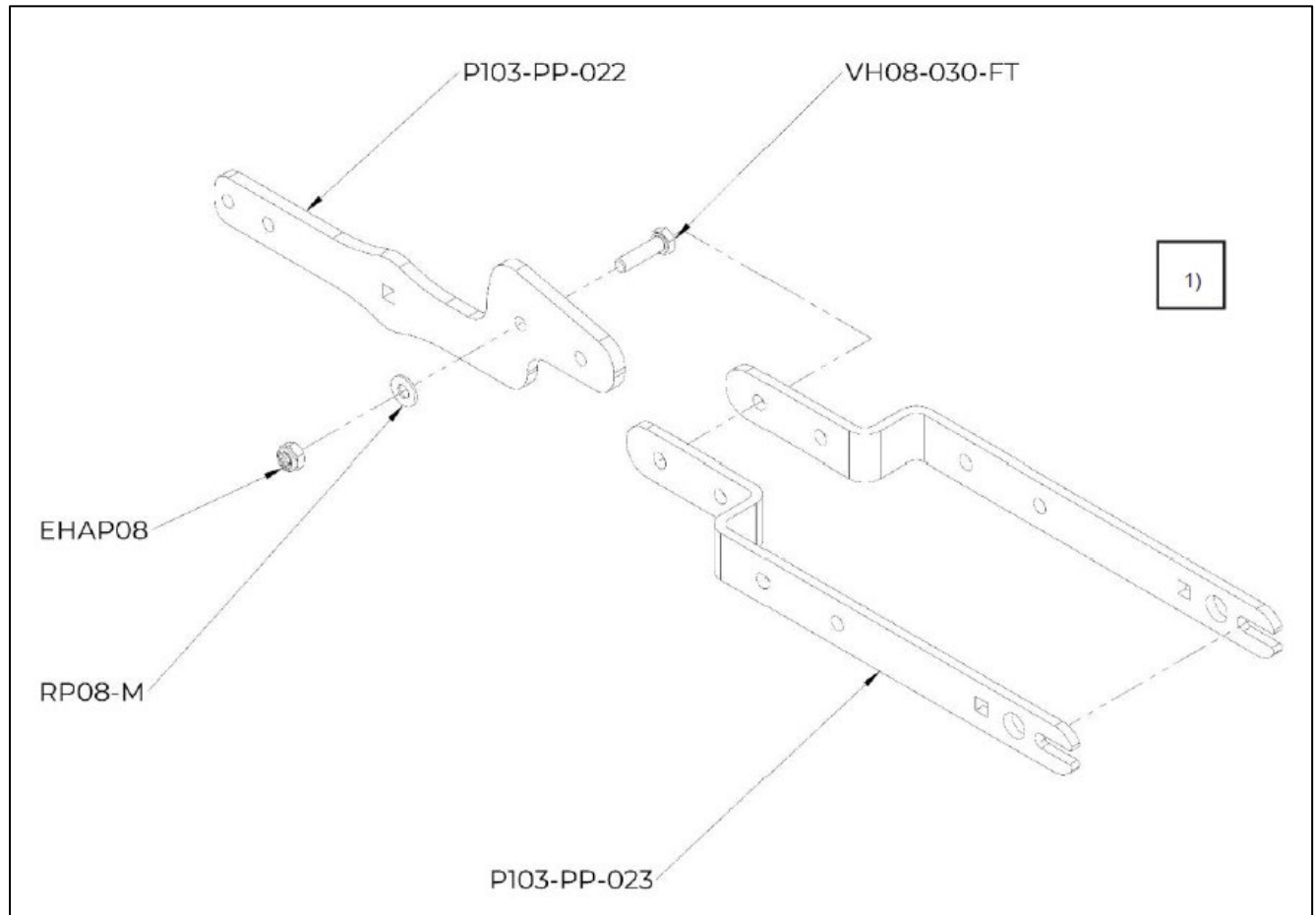

2. Attach the long handles to the assembly created in step #1 above. Insert an M8x45 bolt and M8 washer and nut at the feet of the handlebars to secure. Notice that the handlebars have a slight bend at the feet. Ensure that the feet bend outward. Lightly hand tighten the bolt.
3. Attach mid-handle toolbar supports to the lower portion of the handlebars using two M8x25 bolts, and M8 nuts and washers. Lightly hand tighten the bolts.
4. Attach handle crossbar to the upper portion of the long handles using four M8x25 bolts, and M8 nuts and washers. Lightly hand tighten the bolts.
5. Attach wood handles using M6x20mm bolts.

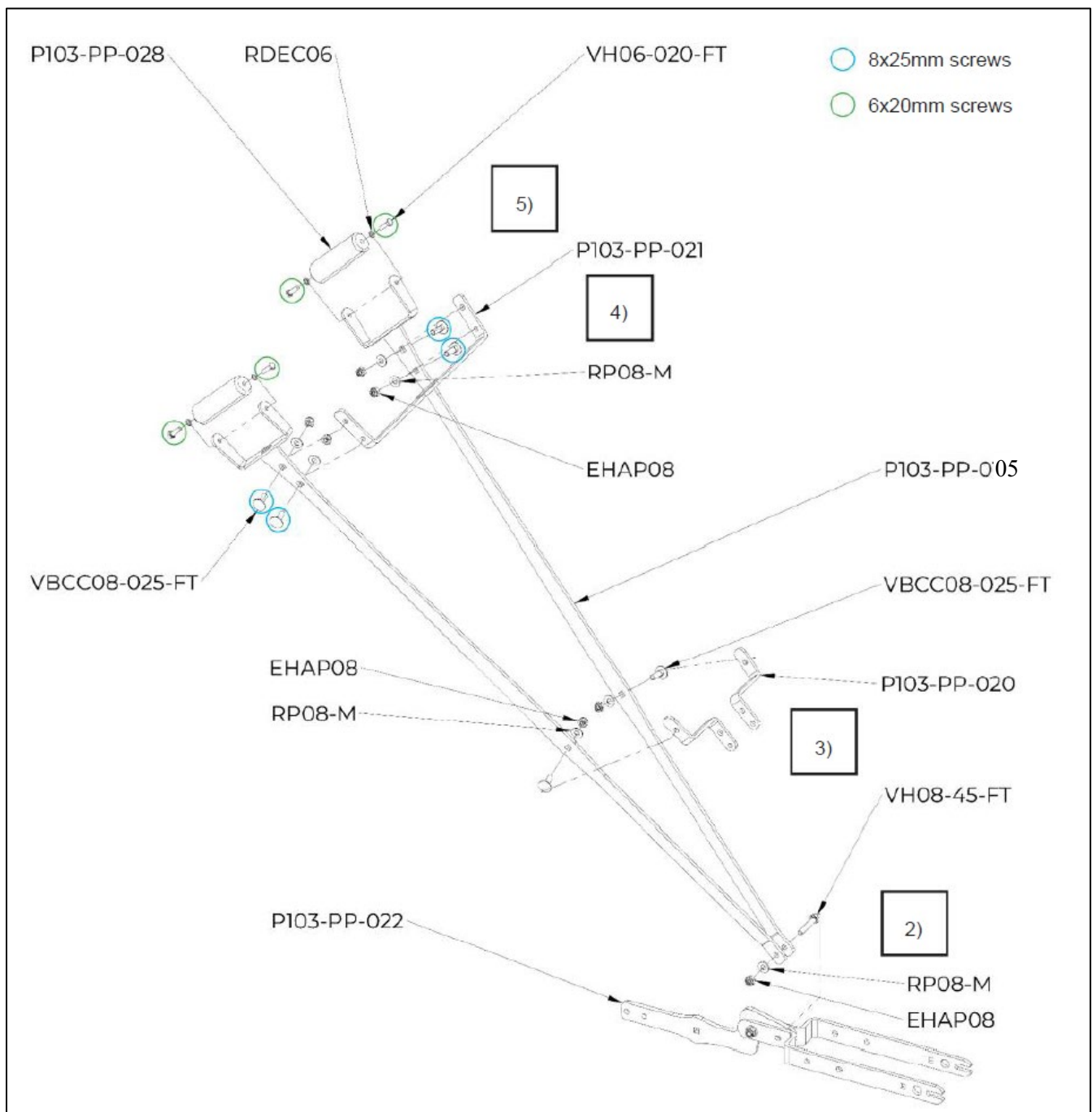

6. Attach toolbar holder onto the toolbar vertical support using M8x30, and M8 nuts and washers. Lightly hand tighten the bolts.
7. Attach the toolbar vertical support to the handlebar assembly by mounting it to the mid-handle toolbar supports using M8x25 bolts, and M8 nuts and washers.

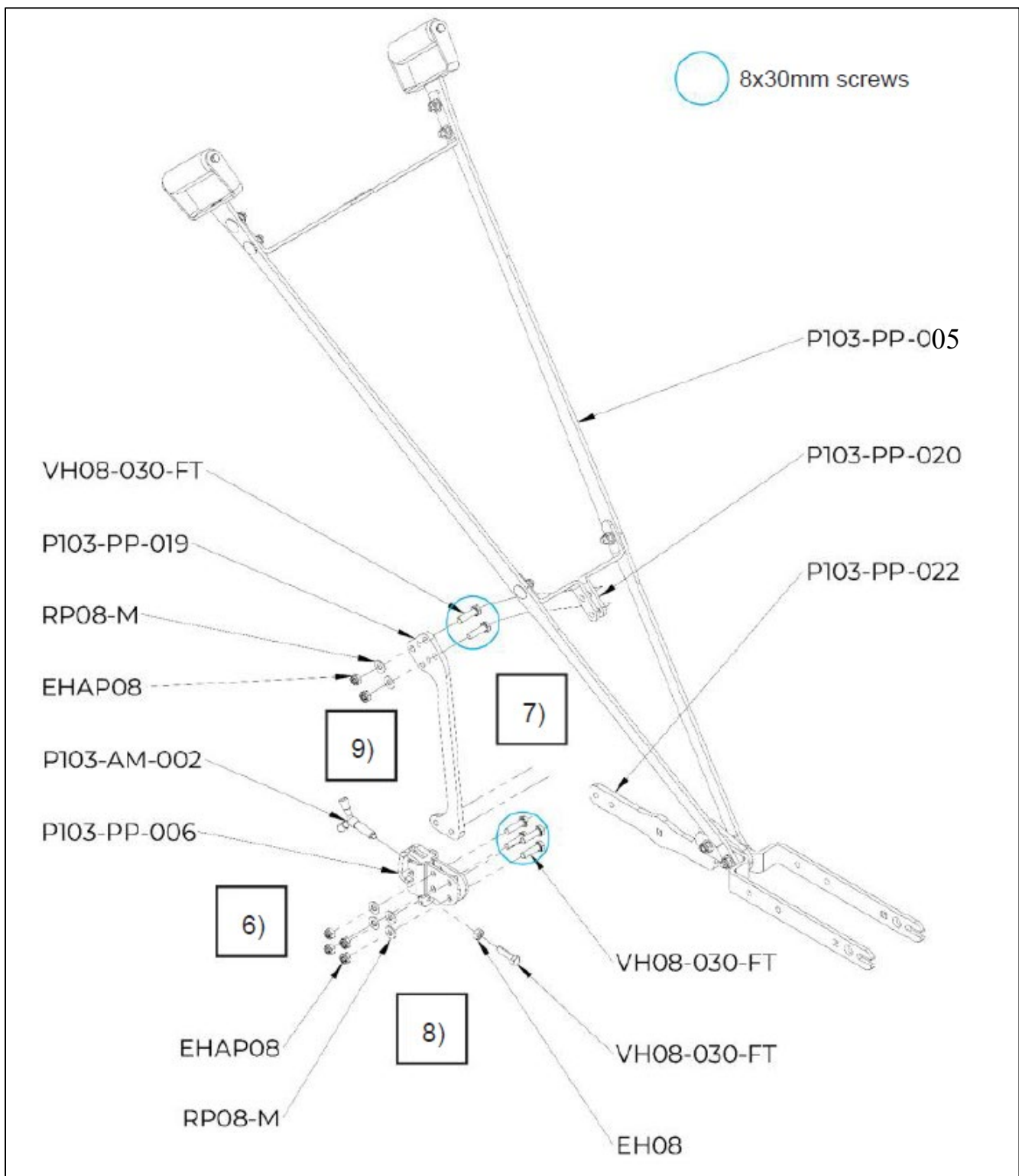

8. Fit a M8x30 bolt with M8 nut into the toolbar holder. It is only necessary to tighten the bolt when mounting a tool attachment.
9. Fit the toolbar clamp into the toolbar holder. It is only necessary to tighten the bolt when mounting a tool attachment.

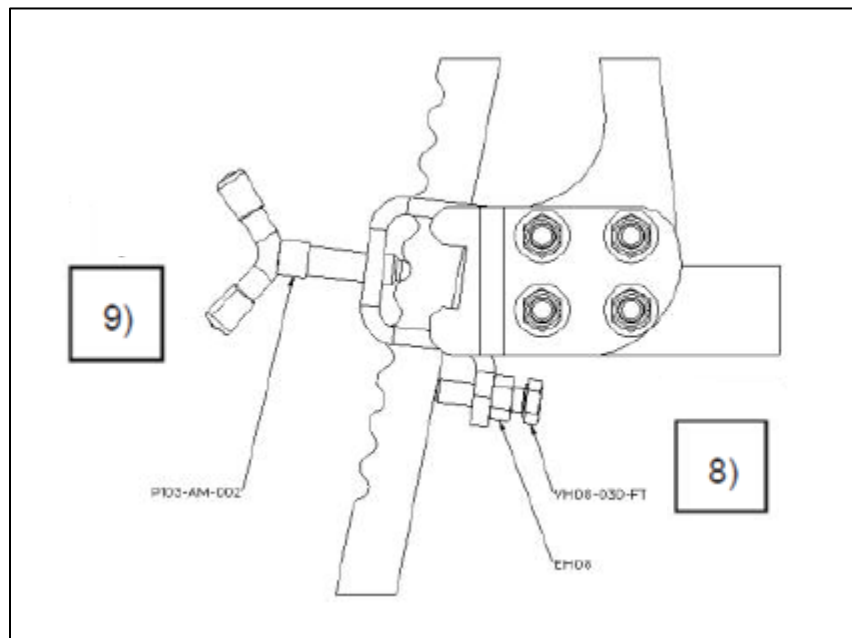

10. Attach the multitool bolt tightener to the toolbar horizontal support with an M8x25 bolt and M8 wingnut.

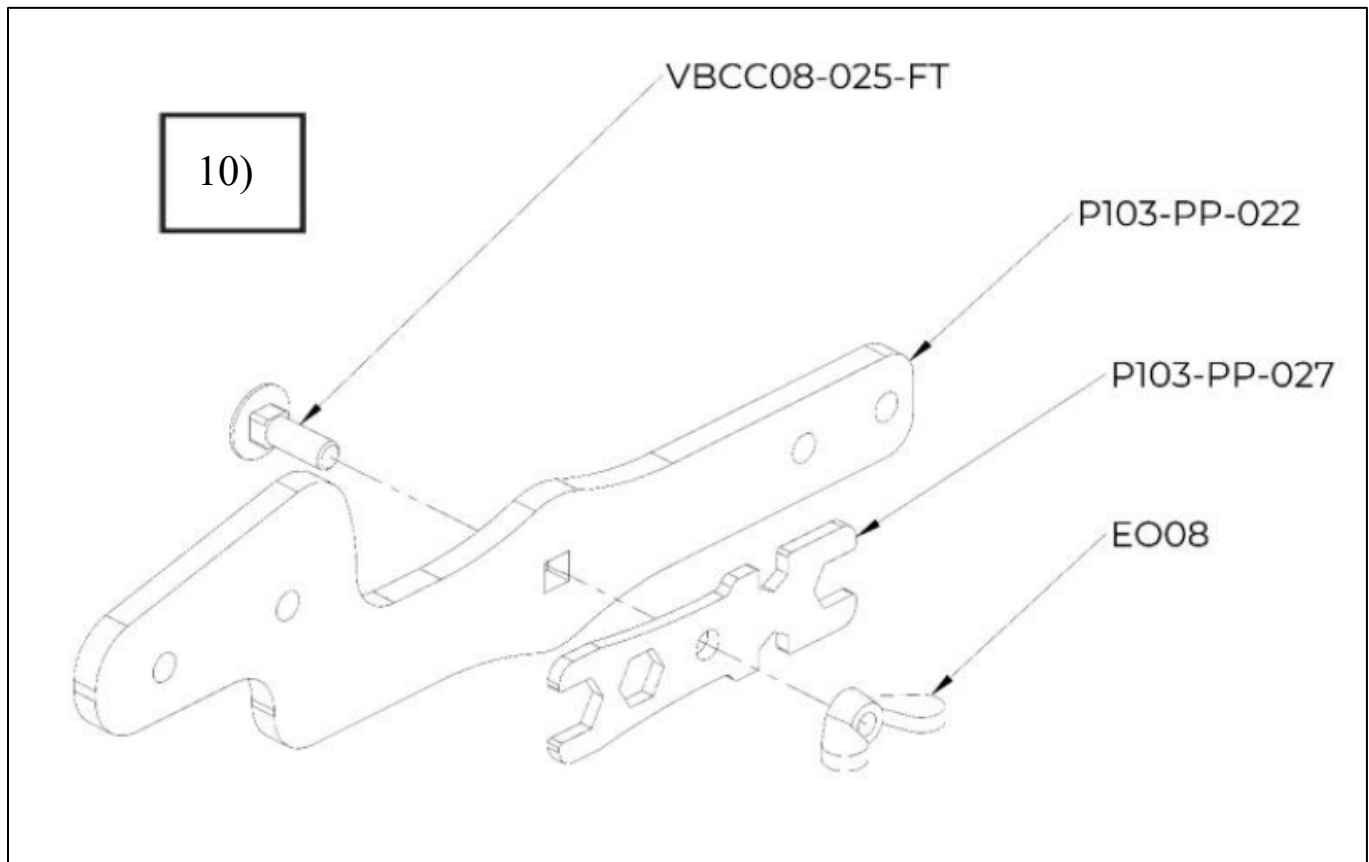

11. If assembling a double wheel hoe, skip to the double wheel hoe assembly instructions below. If assembling a single wheel hoe, proceed to attach the wheel using the M8 wheel nuts.

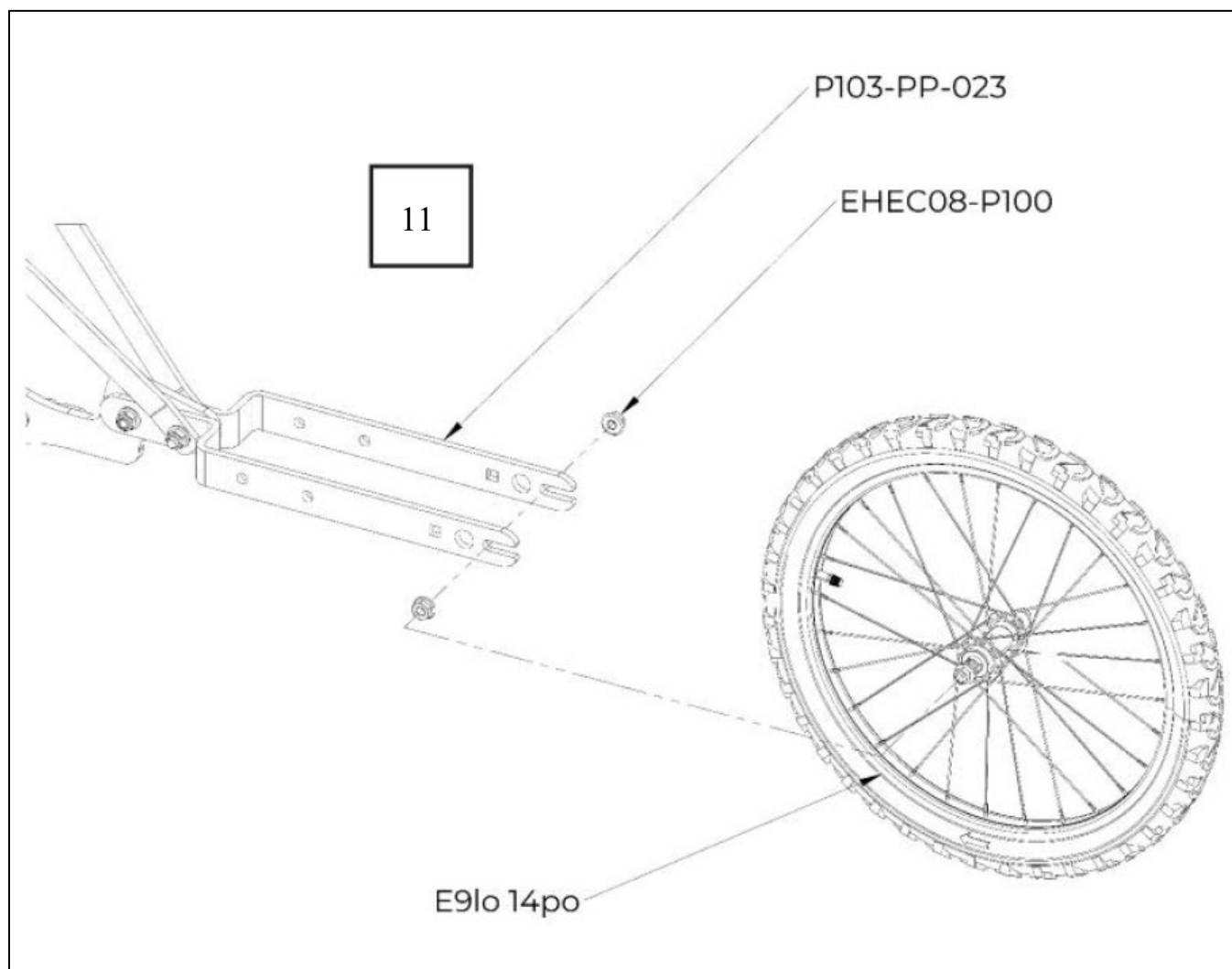

12. Fully tighten all bolts.

Conversion to a Double Wheel Hoe

1. Attach the two-wheel brackets using M8x25 bolts, and M8 nuts and washers.
2. Attach the middle brace using M8 locknuts.
3. Attach the two wheels using the M8 wheel nuts.

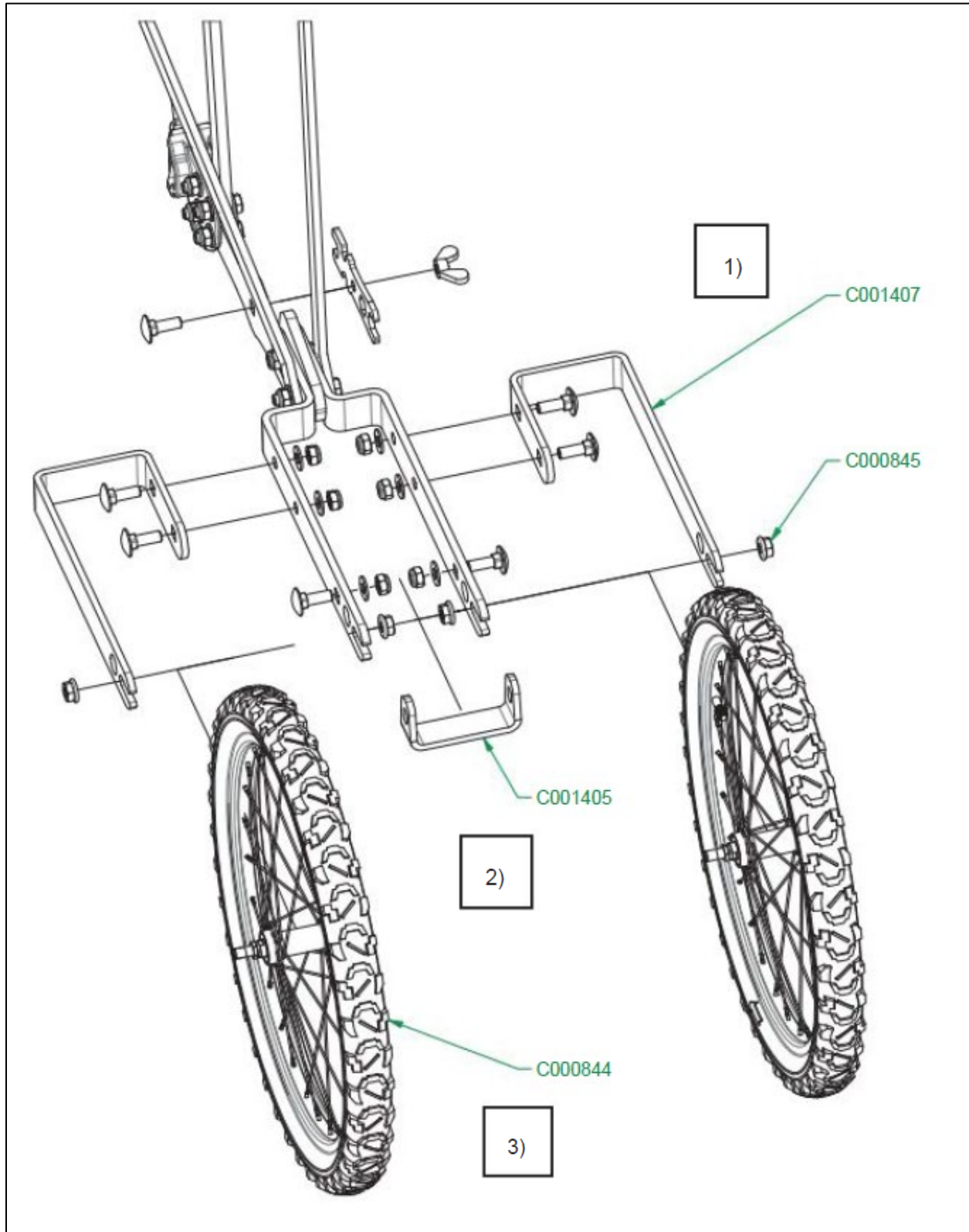

Mounting an Attachment

1. Slide your chosen attachment into the toolbar holder and tighten the butterfly screw. Do not overtighten.
2. Mounting more than one attachment at a time is possible but requires a Secondary Tool Mount, and/or a Toolbar and Tool Support Clamps (sold separately).

Adjusting the Angle of the Attachment

1. Slide the attachment into the toolbar holder.
2. Lightly adjust the pressure from the butterfly screw.
3. Tighten the M8x30 bolt with the multitool bolt tightener. Once you have achieved the desired angle, tighten the M8 locknut to secure the tool in place. **Warning: the toolbar clamp should be used only to adjust the angle of the tool attachment and should not be over-tightened. Over tightening could damage the components.**

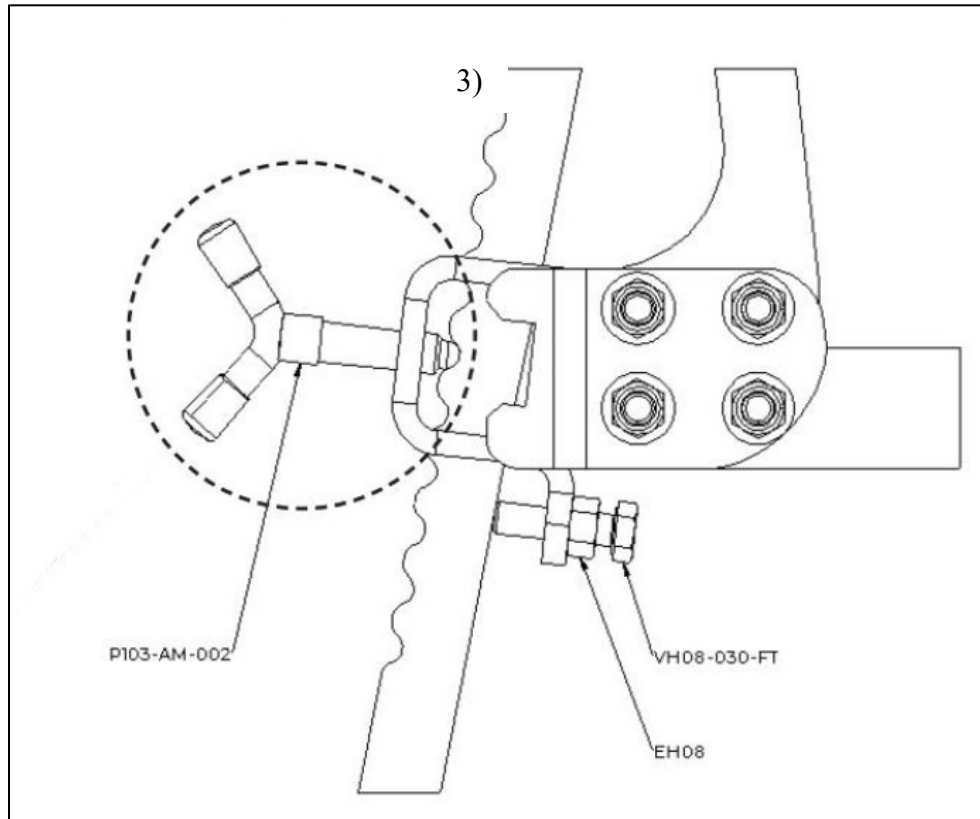

Adjusting Handle Height

1. Loosen the M8x30 bolts and M8 nuts.

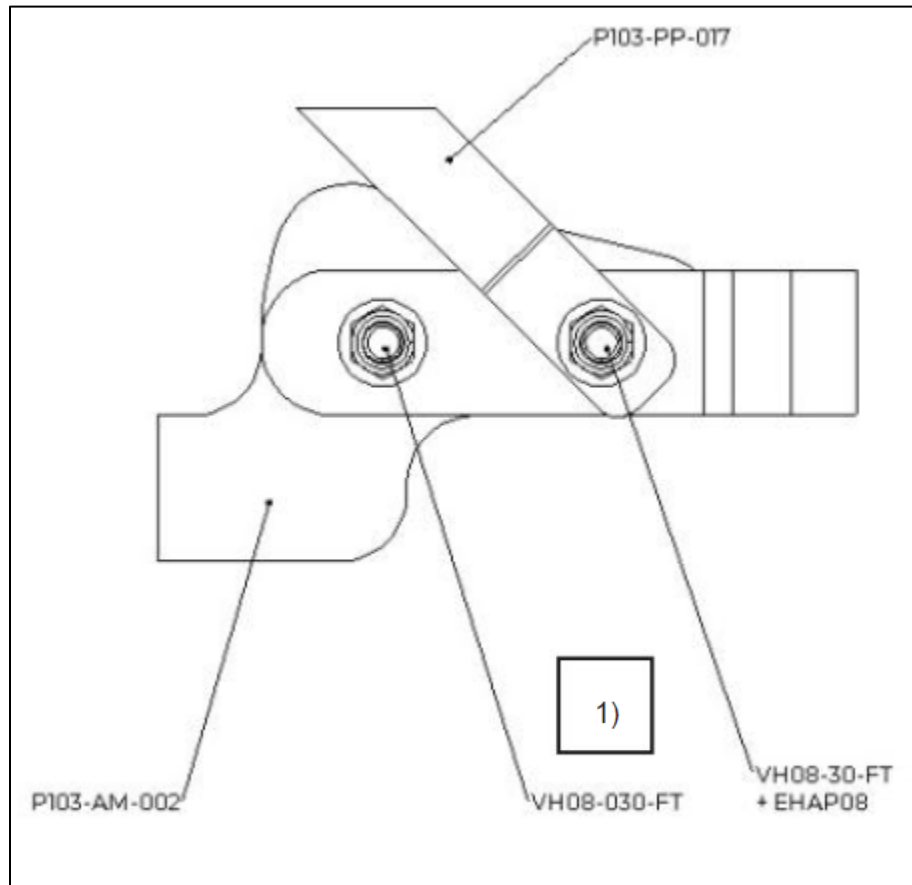

2. Adjust the placement of the pair of bolts according to the desired handle height, as pictured below.

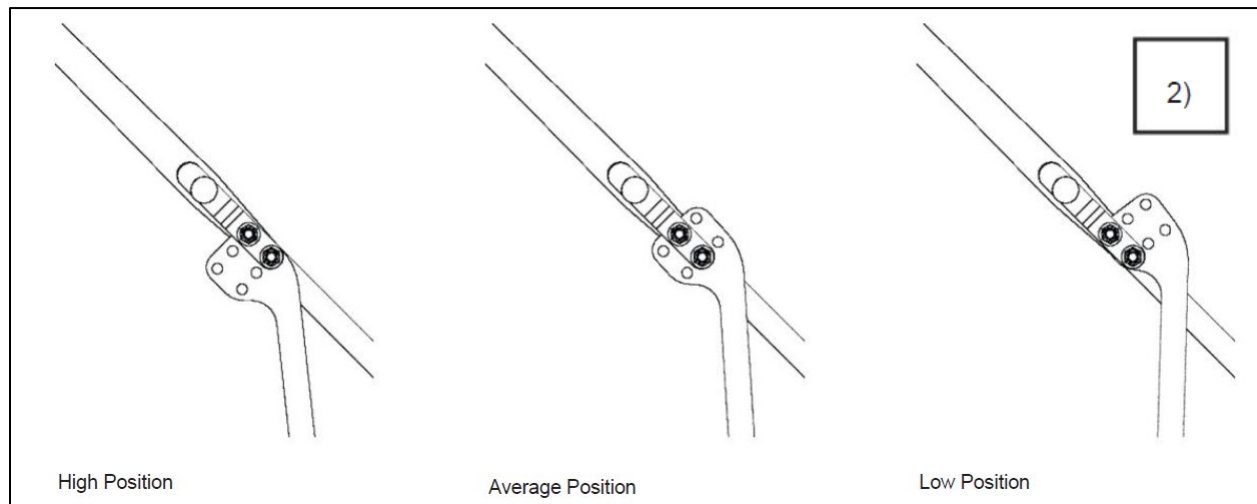

3. Tighten bolts.

Instructions for Use

- Walk at a steady pace, operating your wheel hoe **with a push-pull**, oscillating motion.
- For best results, keep your attachment blades sharpened.

REV 7/02/2025 Id, nm